

EN



Concorde

REISEMOBILE AUS LEIDENSCHAFT

2024



Concorde

REISEMOBILE AUS LEIDENSCHAFT

Welcome to the world of Concorde luxury motorhomes.

Let yourself be inspired by the unique Concorde class. With unusual design, many innovations and the associated high quality, we create the values that provide you the customer with wonderful experiences, unforgettable memories and moments that are in a class of their own.

The energy and passion that our employees put into producing our vehicles is reflected in your motorhome. Our many years of experience and dedication guide us to our goal of making your dreams come true.



Michael Schmitt
Managing Director of Concorde Reisemobile GmbH

CONTENTS

CONCORDE 6

THE CONCORDE CLASS 8

MODEL RANGE 10

THE CONCORDE FAMILY 78

CREDO

SERIES HIGHLIGHTS	12
INTERIOR	14
FLOOR PLAN	18

CARVER

SERIES HIGHLIGHTS	20
INTERIOR	22
FLOOR PLAN	26

CHARISMA

SERIES HIGHLIGHTS	28
INTERIOR	30
FLOOR PLAN	34

CRUISER DAILY

SERIES HIGHLIGHTS	36
INTERIOR	38
FLOOR PLAN	42

CRUISER ATEGO

SERIES HIGHLIGHTS	44
INTERIOR	46
FLOOR PLAN	50

LINER

SERIES HIGHLIGHTS	52
INTERIOR	54
FLOOR PLAN	58

CENTURION

SERIES HIGHLIGHTS	64
INTERIOR	70
FLOOR PLAN	74

“WE ARE PASSIONATE
ABOUT MOTORHOMES”
FOR MORE THAN 40 YEARS



Our success story began in 1981. The many years of experience make us pioneers in this industry. Concorde has been based in Schlüsselfeld-Aschbach (Germany) for more than 28 years and, thanks to a committed management team that has experience in the industry, has developed there into an attractive location with a state-of-the-art motorhome production facility.

Around 400 exclusive, in some cases highly customized, luxury motorhomes leave our factory every year. The precisely balanced combination of individual craftsmanship and precision technology is a key factor in the production of our vehicles.

Our motorhomes are often referred to as land yachts, thereby elevating them to absolute premium products brimming with innovation, precision and passion.



EXPERIENCE QUALITY.

Over its more than 40-year history, Concorde Reisemobile has developed from a pioneer of German motorhome construction into an innovation driver in luxury motorhome production.

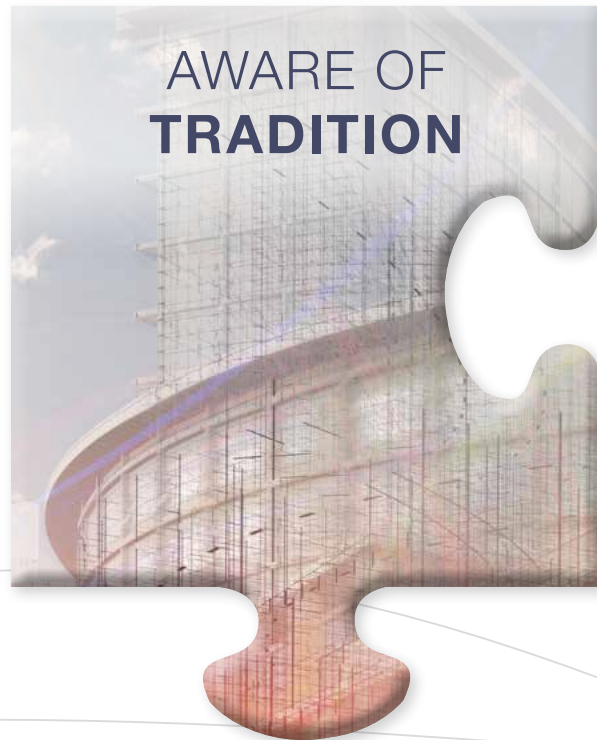

Our unique and exclusive Concorde space and light concept or the phenomenal Concorde storage space concept together with the ergonomic cockpit design create an unmistakable wellness experience.

THE CONCORDE CLASS.



OUTSTANDING INNOVATION

Our own innovations with extraordinary functionality combined with excellent design catapult our motorhomes into the premier league of the luxury sector.



UNRIVALLED QUALITY

The appearance and workmanship characterized by top manufacturing quality and exquisite materials and furnishings maximise sustainability and retain value.

CONCORDE MODEL RANGE



CREDO

CARVER

CHARISMA

**LINER/
CENTURION**



CENTURION

**CRUISER
ATEGO**

**CRUISER
DAILY**

CREDO

CLIMB ABOARD THE CONCORDE CLASS

Traditionally, the Concorde Credo has always been the entry-level motorhome of the Concorde class.

It's obvious at first glance that the Credo is a true Concorde. The large bus mirrors, the bus windscreen wipers and the optional exterior design in Centurion style are unmistakable elements of the Concorde DNA. The frameless and flush-mounted side windows in the driver's cab are particular quality features of the Credo.

Price list

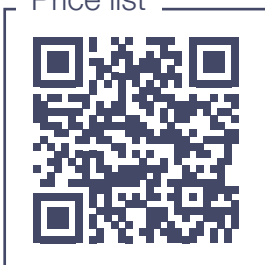

Exterior

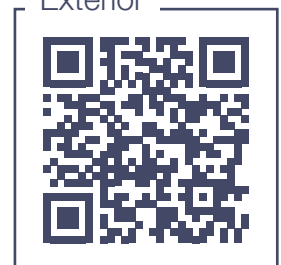

The wellness oasis with separate toilet room offers them a spacious area for their personal refreshment. Two doors separate it from the bedroom and living room.



The coach-style rear-view mirrors, which are elegant and ensure optimum visibility, increase active safety while driving and, above all, when manoeuvring.



A remote control, which is integrated in the ignition key of the basic vehicle, automatically locks and unlocks the entrance door.



The steering wheel, which is easy to remove and attach, provides a significant increase in comfort, freedom of movement and safety with its functionality optimised by Concorde.



Highlights

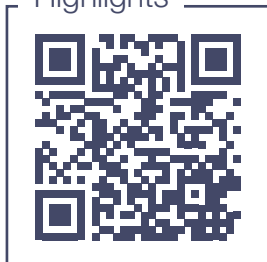

CREDO

CARVER

CHARISMA

CRUISER DAILY

CRUISER ATEGO

LINER

CENTURION



CREDO

Concorde



CONCORDE

TRUZE



CREDO

Clubmark
certified
by



CREDO

ENTRADA





CREDO 840 LI

CONCORDE DNA - VISIBLE AT FIRST GLANCE

Of course, our motorhomes impress at second glance too. For example the living room in the Concorde Credo. A bright, friendly living environment and the decorative, upholstery and carpet fabrics are all perfectly matched to the furnishings. Alternating convex and concave surfaces and the "Concorde One Level Concept" create a continuous spatial impression from the driver's cab all the way to the bedroom.

The kitchen is a clear statement of quality and function in Credo. With its three-flame cooker, single-lever mixer tap, perfectly integrated sink, kitchen waste container or multifunctional hanging rail, the large kitchen of the Credo models sets standards in its class, both in ergonomics and in design and function.

Interior



Learn about the large selection of furniture front panels and seating group variants with their leathers and fabrics.



CREDO 840 LI

CREDO

CARVER

CHARISMA

CRUISER DAILY

CRUISER ATEGO

LINER

CENTURION

THE LUXURIOUS WELLNESS EXPERIENCE

You enjoy a refreshing start to your day? No problem. The bathroom in the Concorde Credo models also provides plenty of space. By closing the doors to the living room and bedroom, the separate shower and toilet are instantly transformed into a spacious bathroom with dressing room.

To help you relax after a busy day, our designers have really thought of everything in the sleeping space of the Concorde Credo models. Apart from the generously proportioned bed, there is also the Concorde sleeping system: A perfect combination of comfortable mattress with spring base which ensures a particularly peaceful and restful sleep.

CREDO 840 LI

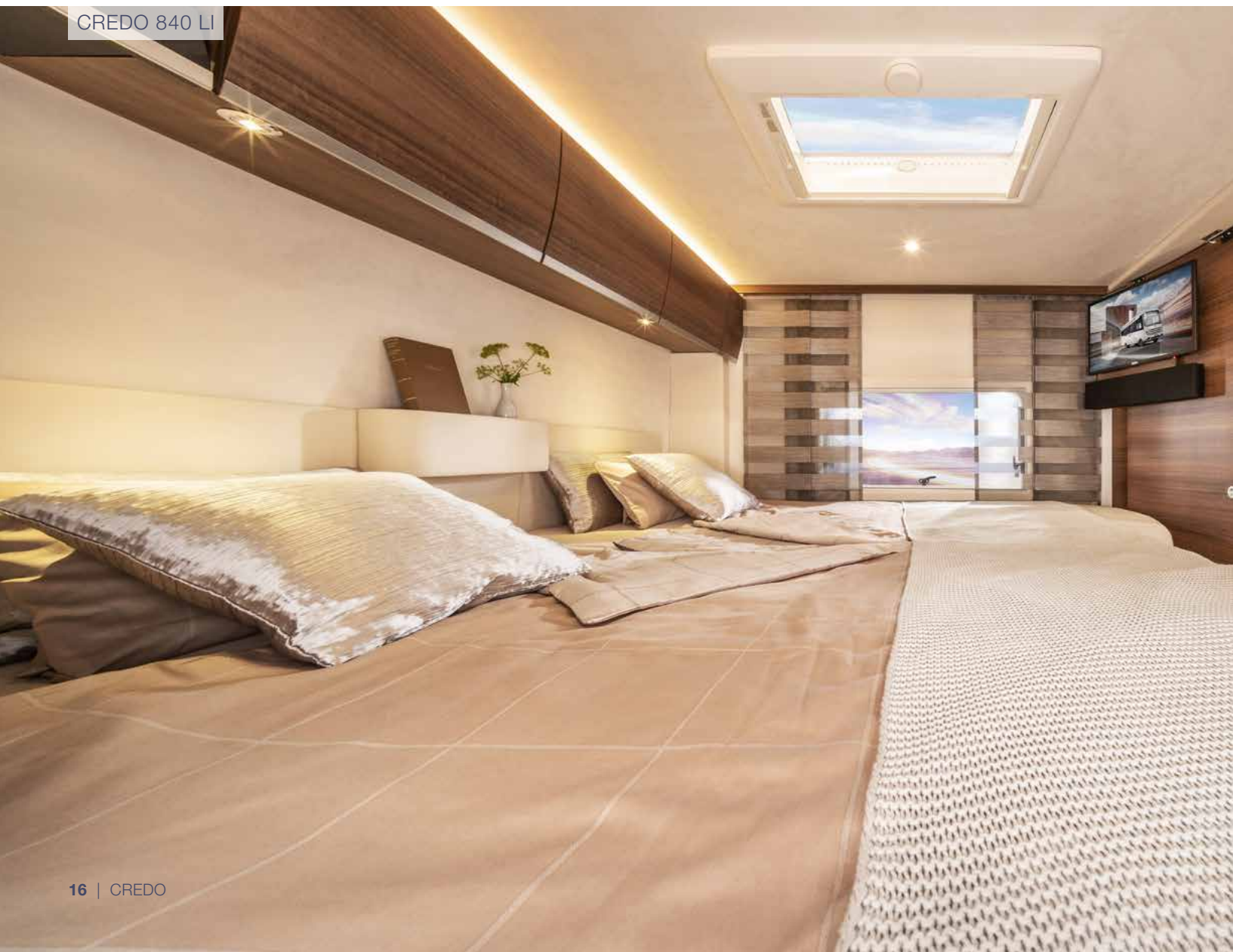



CREDO 740 HI



CREDO 840 LI

CREDO

CARVER

CHARISMA

CRUISER DAILY

CRUISER ATEGO

LINER

CENTURION

Technical data



741 HI

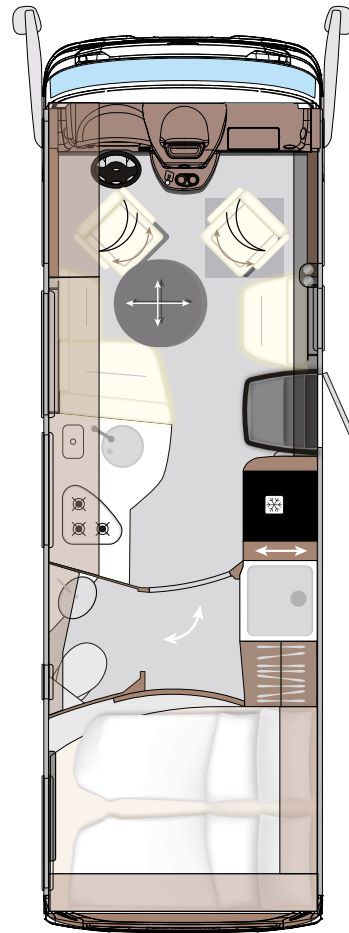

BASIC VEHICLE	Iveco Daily
OVERALL LENGTH (mm)	7490
OVERALL WIDTH (mm)	2330
OVERALL HEIGHT (mm)	3210
MAXIMUM TECHNICALLY-AUTHORISED GROSS VEHICLE WEIGHT (kg)	5200
PAYLOAD (kg)	1115

791 LI

791 MI

840 LI

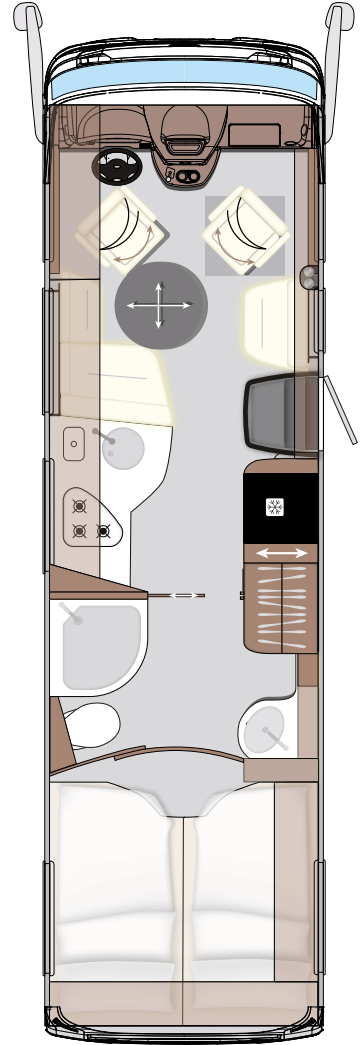
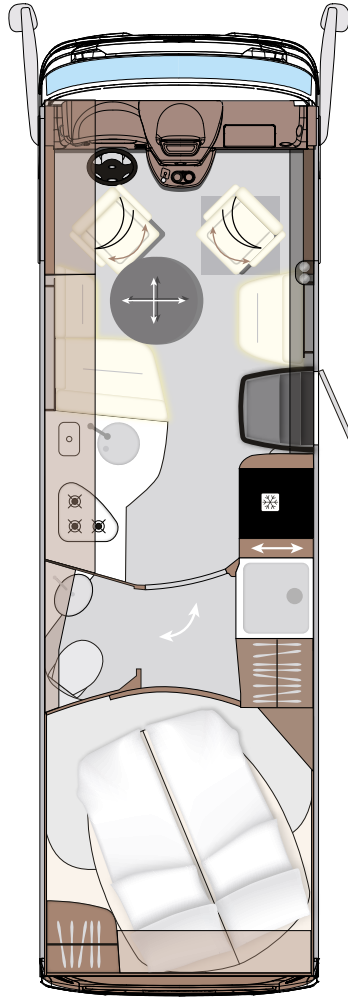
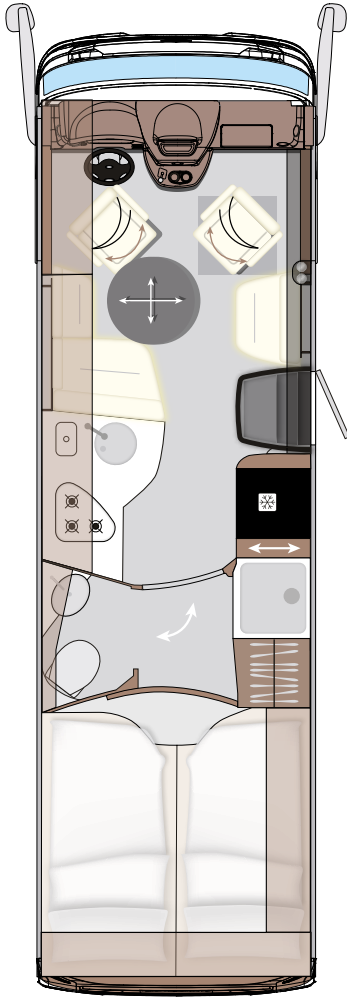

Iveco Daily

7990

2330

3210

5200

1015

Iveco Daily

7990

2330

3210

5200

1015

Iveco Daily

8490

2330

3210

5200

935

CARVER

LUXURY MADE EASY

The Carver makes mobile luxury easy.

With its Concorde-typical exterior design, the Carver visually conveys a certain lightness in spite of its voluminous appearance.

In fact, the Carver reduces its weight through the intelligent use of materials. Despite its material lightness, the vehicle features a plethora of innovative technology, tried-and-tested functionality and a high degree of winter hardness.

Price list



Exterior



Two aluminium frames in the Charisma's double floor ensure an extremely stable "basement construction" by connecting the auxiliary frame with the living area floor, creating a solid box. This clever construction means that furniture and wall constructions remain firmly connected in the long run.



The elegant and functional aluminium front blind provides the required privacy and protects against unwanted sunlight.



Even mobile homes need a sound foundation. This is ensured by sturdy machine screws that sturdily secure the bottom floor of the chassis.



The heated double floor with substantial interior height offers a generous amount of storage space and is easily accessible through the large storage space flaps, which can be rotated by 180°.



Highlights



CREDO

CARVER

CHARISMA

CRUISER DAILY

CRUISER ATEGO

LINER

CENTURION



CARVER

Concorde

CONCORDE

powered by IVECO



CARVER



CARVER



STYLISH AND FUNCTIONAL

The kitchen is among the highlights of the Carver. The ergonomic kitchen ensemble with mineral kitchen worktop, stainless-steel hob and stainless-steel sink as well as the typical household accessories has been thought out by us down to the last detail and is combined with optimum room usage and exemplary equipment.

The living room provides a perfect combination of functionality and comfort with ergonomically shaped seating group and a lightweight furniture concept with a range of design variants.

Interior



Learn about the large selection of furniture front panels and seating group variants with their leathers and fabrics.



CARVER 890 RRL



CREDO

CARVER

CHARISMA

CARVER 790 L, EBANO SILVER MODEL OVERHEAD CABINET



CRUISER DAILY

CRUISER ATEGO

LINER

CENTURION



CARVER 790 L

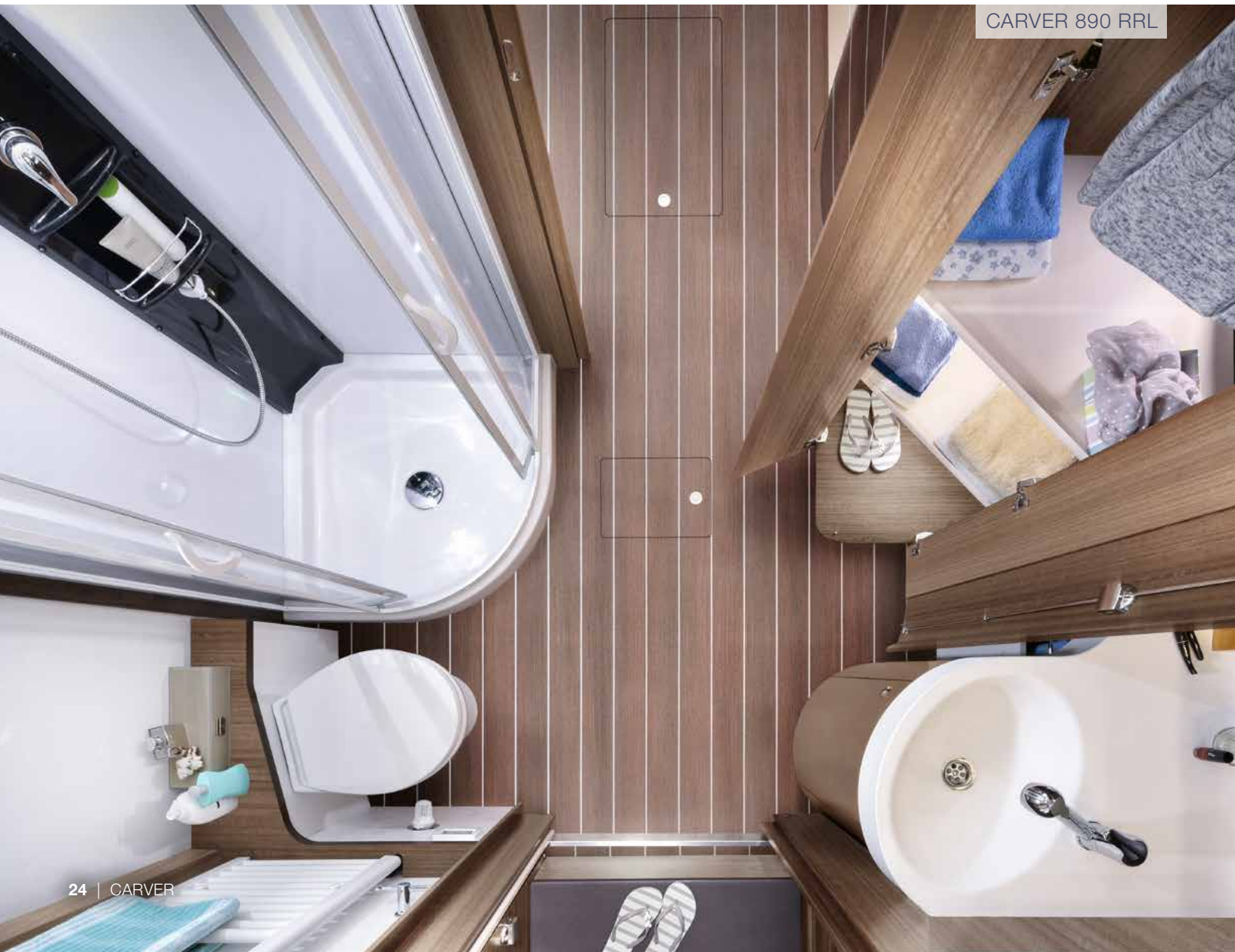

CARVER 890 RRL

OASES OF WELL-BEING AND RELAXATION

Not only the Carver has a smart appearance, so too do its owners. Ensuring this is the spacious bathroom with its separate shower, toilet, washbasin, numerous storage areas as well as a large wardrobe. Hygiene, cleanliness and visible care are apparent not only in the "all-round" mirrors.

For external care of the body to continue, the sleeping area offers maximum comfort. A special spring base, comfortable cold-foam mattresses as well as cushioned headrests ensure relaxing and healthy sleep.

CARVER 890 RRL



CREDO

CARVER

CHARISMA

CRUISER DAILY

CRUISER ATEGO

LINER

CENTURION



790 L

791 RL

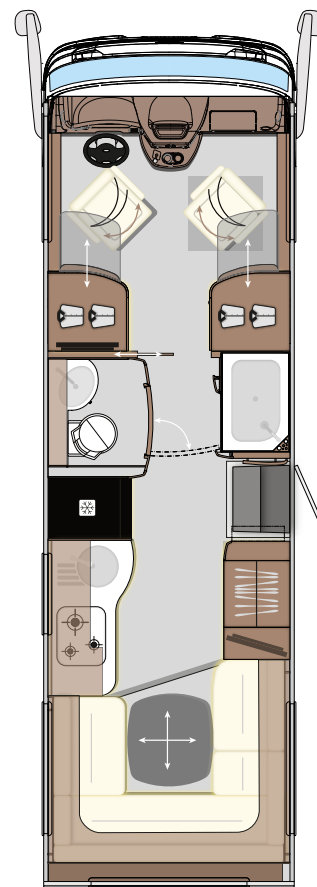
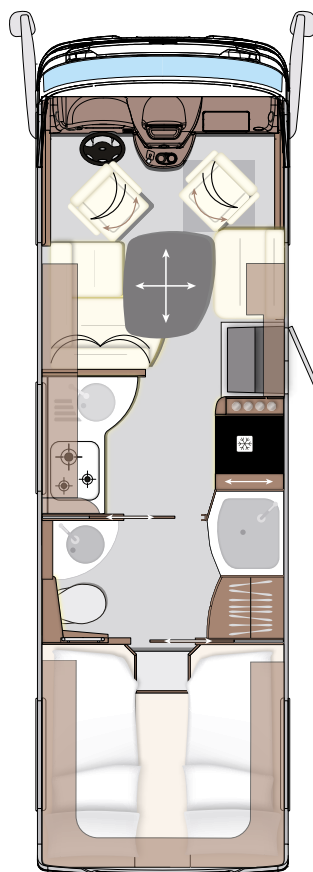

BASIC VEHICLE

Iveco Daily

Iveco Daily

OVERALL LENGTH (mm)

7990

8085

OVERALL WIDTH (mm)

2400

2400

OVERALL HEIGHT (mm)

3460

3460

MAXIMUM TECHNICALLY-AUTHORISED
GROSS VEHICLE WEIGHT (kg)

6500

6500

PAYLOAD (kg)

1245

1320

850 L

890 RRL

920 G

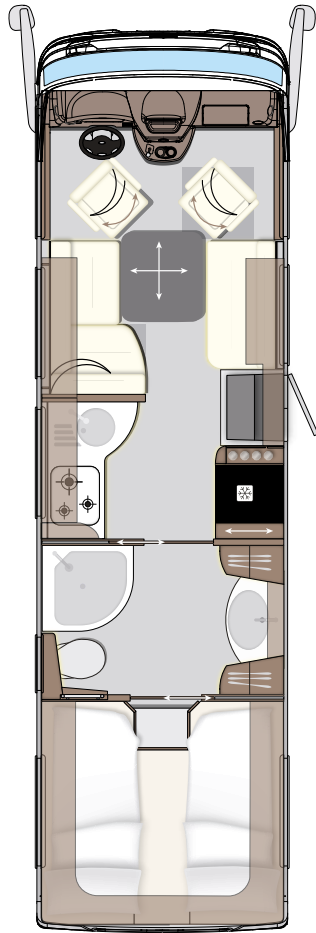

Iveco Daily

8590
2400
3460
6500
1220

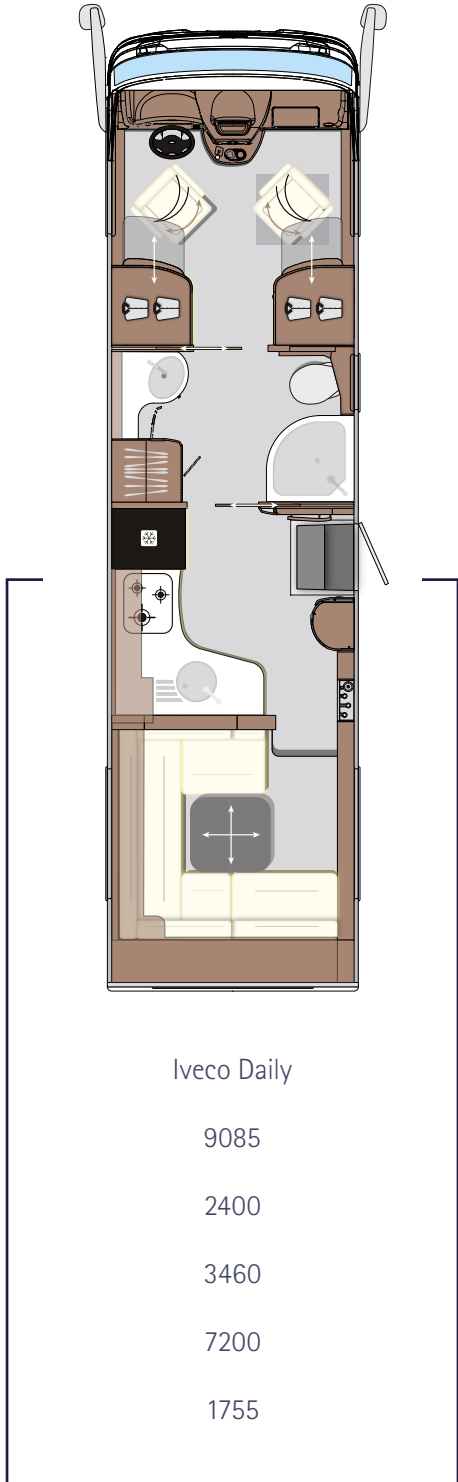

Iveco Daily

9085
2400
3460
7200
1755

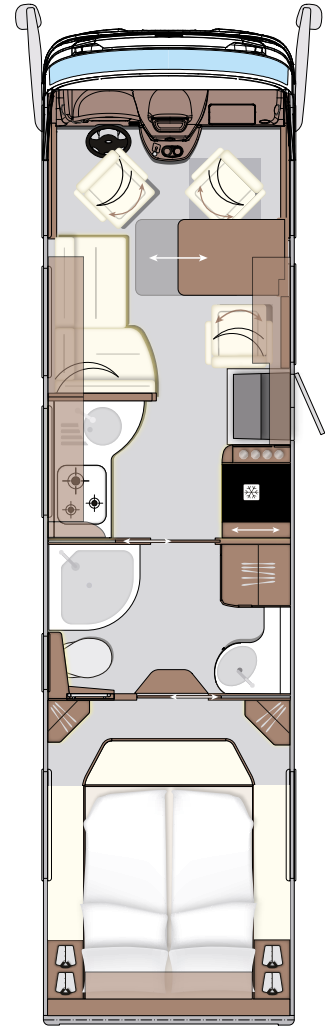

Iveco Daily

9450
2400
3460
7490
1905

CREDO

CARVER

CHARISMA

CRUISER DAILY

CRUISER ATEGO

LINER

CENTURION

CHARISMA

THE CLASSIC

The classic among the land yachts.

The Charisma stands for all of the values Concorde represents with its company philosophy: innovation, quality and passion. Demonstrated by state-of-the-art and innovative vehicle technology, luxurious and practically oriented equipment as well as artisanal passion and material quality.

The current generation embodies progressive design, intelligent technology and uncompromising comfort and is a leader in style and exemplary for luxury motorhomes, also known as land yachts.

Price list

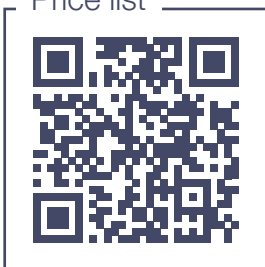

Exterior



Storage space „en masse“: Through the optimum utilization of the storage resources on board, it has been possible to create space for drawers, cabinets and work surfaces despite the limited space availability.



The dashboard is ergonomically designed so that the driver always has the essential vehicle data in sight and can easily reach all function switches and levers.



The multifunctional adjustable hot water heating system creates three different warm areas which can be heated separately from each other. The two-circuit underfloor heating enables separate control of living room and bathroom.



The double floor offers an optimal through-loading capacity over the entire vehicle width, for skis, surfboards or other boards and bulky objects in general.



Highlights



CREDO

CARVER

CHARISMA

CRUISER DAILY

CRUISER ATEGO

LINER

CENTURION



CHARISMA

Concorde



CONCORDE

powered by IVECO









LIVING ENVIRONMENT AND KITCHEN STUDIO

The living room as a living environment. Depending on the model: with bar version or a fifth seating place as a generously dimensioned lounge version, equipped to a high standard and unbelievably comfortable. The integrable driver's seat and passenger's seat offer additional living space.

The kitchen – a studio par excellence. Extendable pull-out pantries with plenty of storage space. High-quality kitchen appliances, a spacious refrigerator, the stainless-steel hob and integrated stainless-steel sink in the ergonomic mineral worktop convey a kitchen studio atmosphere.

Interior



Learn about the large selection of furniture front panels and seating group variants with their leathers and fabrics.



CREDO

CARVER

CHARISMA

CRUISER DAILY

CRUISER ATEGO

LINER

CENTURION

WELLNESS OASIS AND RELAXATION CENTRE

The bathroom – a wellness oasis! Tastefully furnished, it spans the entire width of the vehicle and has a spacious feeling. High-quality stainless-steel fittings, sink and shower basin made of artificial stone convey an exclusive wellness atmosphere.

The bedroom – a centre of relaxation! The high-quality Concorde sleep system with deluxe mattress and sturdy spring base ensures maximum comfort; the substantial bed dimensions provide a feeling of total relaxation.





CREDO

CARVER

CHARISMA

CRUISER DAILY

CRUISER ATEGO

LINER

CENTURION

Technical data



860 LI

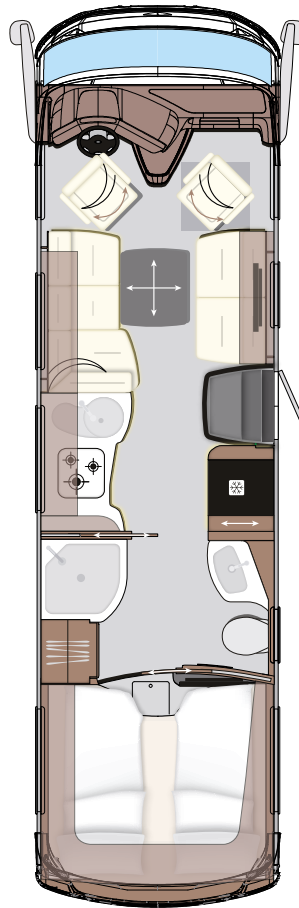

BASIC VEHICLE	Iveco Daily
OVERALL LENGTH (mm)	8770
OVERALL WIDTH (mm)	2420
OVERALL HEIGHT (mm)	3540
MAXIMUM TECHNICALLY-AUTHORISED GROSS VEHICLE WEIGHT (kg)	6500
PAYLOAD (kg)	1035

910 LI

910 MI

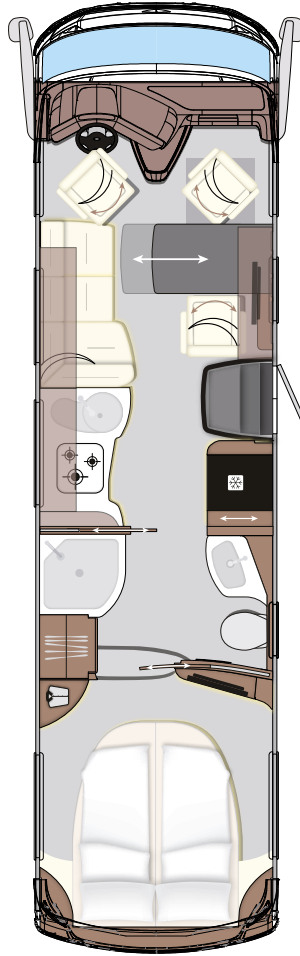
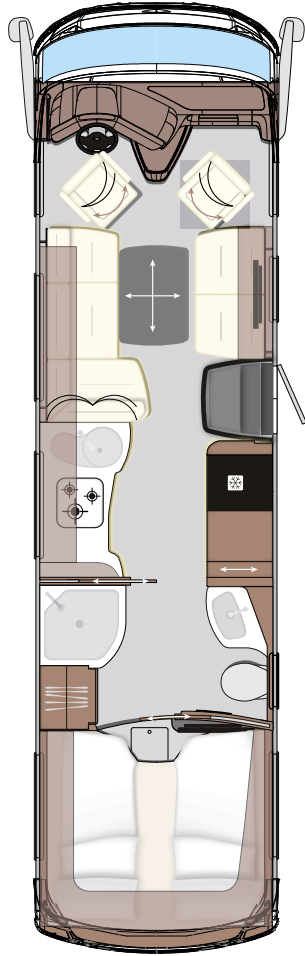

Iveco Daily

9270

2420

3540

6500

825

Iveco Daily

9270

2420

3540

6500

825

CREDO

CARVER

CHARISMA

CRUISER DAILY

CRUISER ATEGO

LINER

CENTURION

CRUISER DAILY

THE ALL-ROUNDERS

The perfect combination of mobility, size and performance.

The Cruiser represents the alcove tradition at Concorde. Proven technology and comfortable equipment are the result of many years of experience in motorhome construction. While the smaller models on an Iveco chassis are especially attractive to a casual clientele, the larger models stand for substantial spaciousness, high payload and impressive performance.

Price list



Exterior

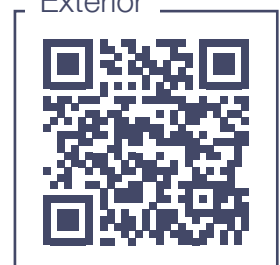

Heavy equipment strongly strains the garage floor. The aluminium checker plate ensures permanent protection, regardless of what you are transporting!

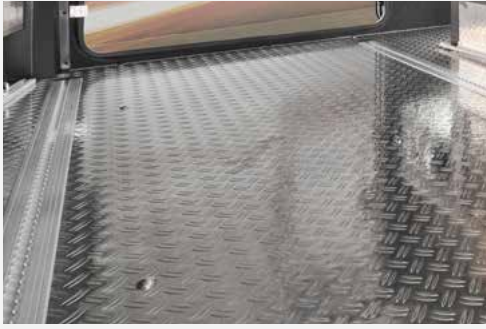

Thanks to the specially insulated and separately heatable cabin layout, the Cruiser models are ideally suited to winter use.



A stable pipe system, i.e. no flexible hoses, offers water pressure and supply just like at home. Smooth pipe walls prevent deposits and ensure excellent hygiene.



The heatable double floor with enormous internal height offers generous storage space. Storage space flaps that swivel 180° make loading bulky objects easy.



Highlights



CREDO

CARVER

CHARISMA

CRUISER DAILY

CRUISER ATEGO

LINER

CENTURION



Concorde

CENTURION
Style

CONCORDE

powered by IVECO



CRUISER





IVECO

CONCORDE

Iveco: RESPONSABILE - 0.9110 Autostar

CONCORDE



SPECIALITIES OF THE HOUSE

With the separate sleeping space in the alcove, the remainder of the floor plan and especially the living and kitchen areas have particular importance. At Concorde, kitchens are a speciality of the house. Every corner is utilized with an intelligent storage space system. Function and design are exemplary. The technical equipment satisfies even kitchen professionals. The living area, with Concorde's round seating group at the rear, offers fantastic impressions and views. Ergonomically optimized seating and living-room furniture convey an unparalleled atmosphere.

Interior



Learn about the large selection of furniture front panels and seating group variants with their leathers and fabrics.



CREDO

CARVER

CHARISMA

CRUISER DAILY

CRUISER ATEGO

LINER

CENTURION

THE OASES OF WELL-BEING

The bathroom and sleeping area are perfect places of retreat to recharge body and soul. Spacious shower, extensive washbasin, comfortable toilet and a walk-in wardrobe are an optimum ensemble for daily body care.

Comfortable twin beds with convenient access via sliding steps as well as a substantial height with headroom in the alcove offer an oasis of tranquility for restful sleep.

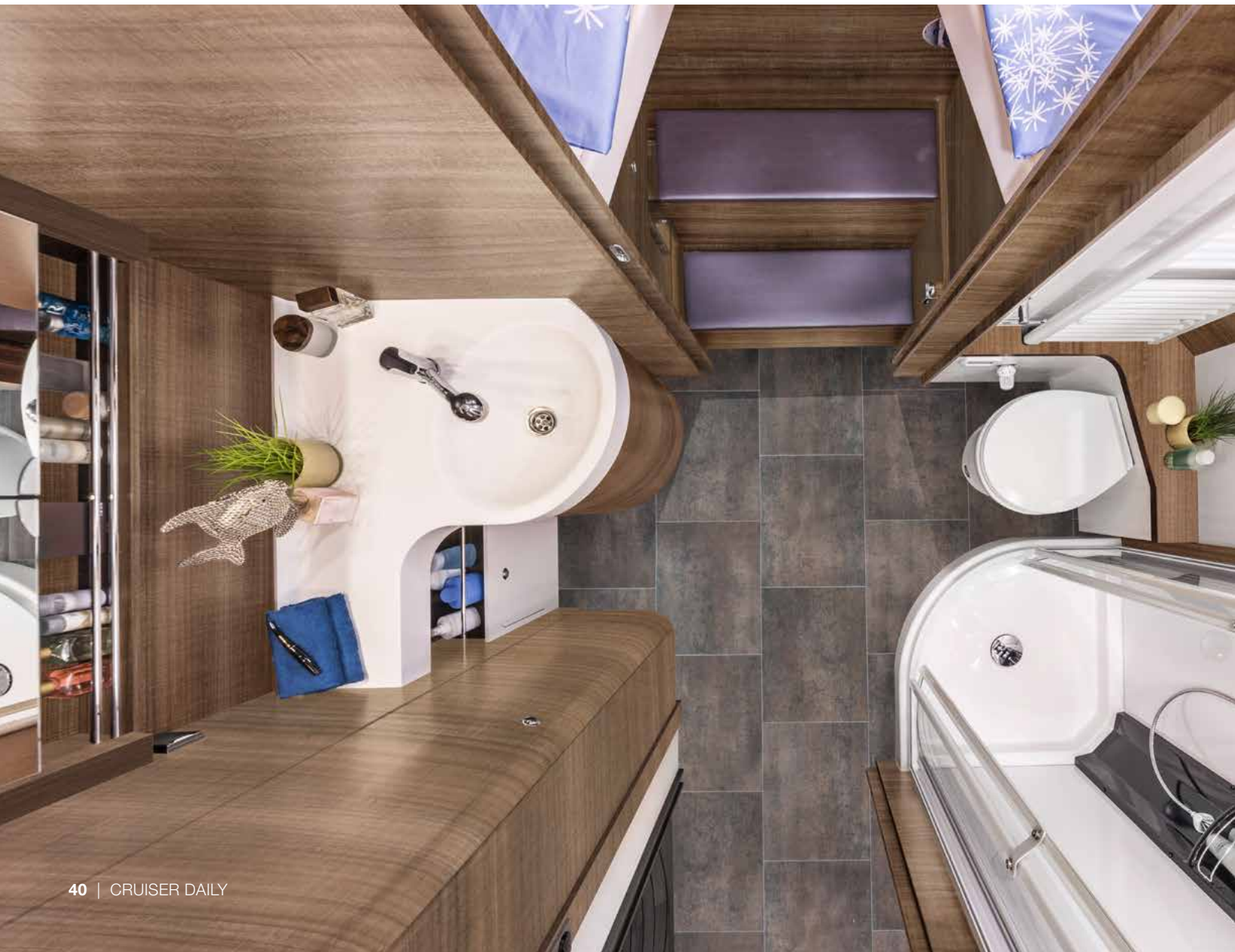



CREDO

CARVER

CHARISMA

CRUISER DAILY

CRUISER ATEGO

LINER

CENTURION

Technical data



791 RL

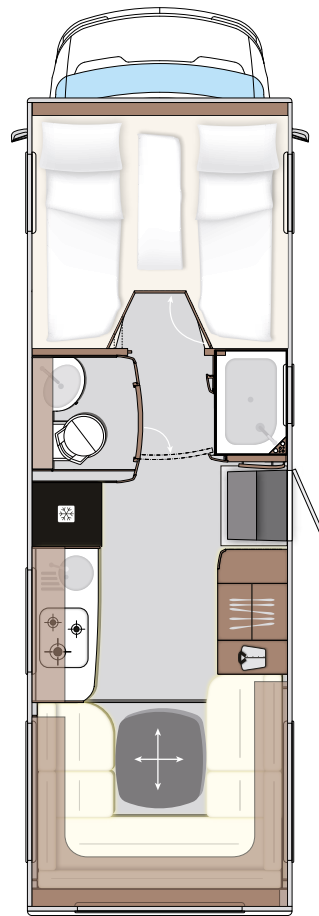

BASIC VEHICLE	Iveco Daily
OVERALL LENGTH (mm)	7990
OVERALL WIDTH (mm)	2380
OVERALL HEIGHT (mm)	3550
MAXIMUM TECHNICALLY-AUTHORISED GROSS VEHICLE WEIGHT (kg)	6500
PAYLOAD (kg)	1630

890 RRL

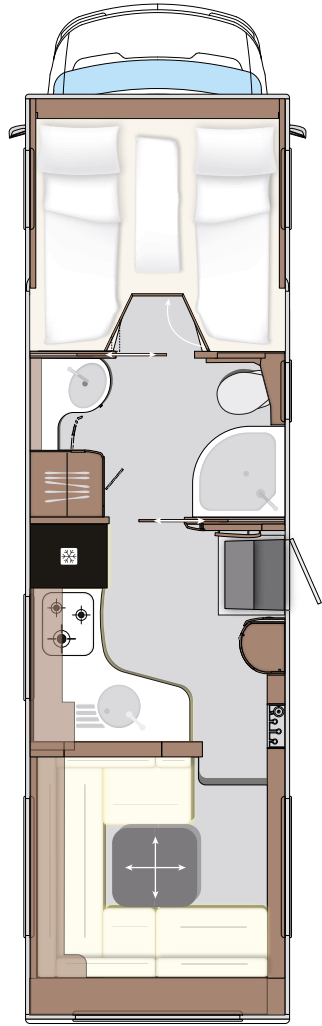

Iveco Daily

- 8990
- 2380
- 3550
- 7000
- 1870

891 L

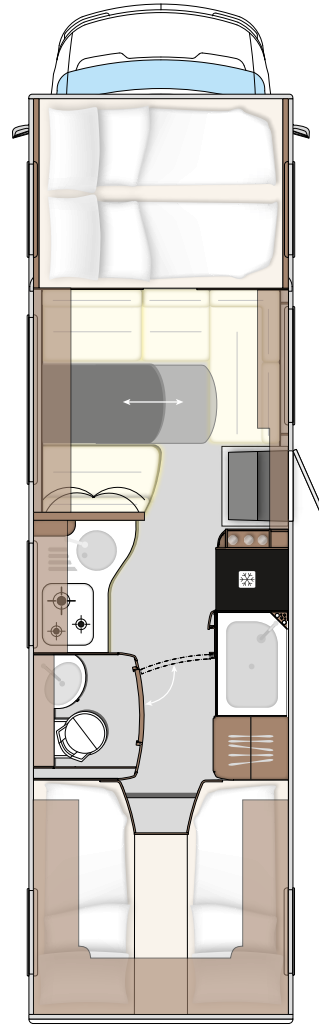

Iveco Daily

- 8990
- 2380
- 3550
- 7000
- 1870

CREDO

CARVER

CHARISMA

CRUISER DAILY

CRUISER ATEGO

LINER

CENTURION

CRUISER

ATEGO

THE POWER PACK

The Cruiser on Atego impresses with its rear-wheel drive, unbridled power and the highest level of functionality. A high seat position provides optimum all-round visibility for a safe and enjoyable driving experience. It is a winterproof alcove of the luxury class which – with a special sense of space, substantial size and payload as well as an extremely high level of performance – ensures uninhibited mobility. Four especially comfortable beds and an intelligent storage space concept offer plenty of room for people and materials alike.

Price list

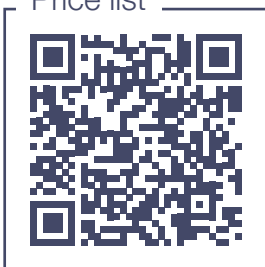

Exterior



The integrated awning perfectly blends into the vehicle body both visually and aerodynamically. As an almost invisible accessory, it does an excellent job of providing plenty of shade.



The reclining chair – an additional piece of furniture with relaxing recliner/seat function – complements the existing range of comfortable seating.



The multifunctional adjustable hot water heating system creates three different warm areas which can be heated separately from each other. By means of a thermostatic valve, the temperature of the living room, wellness area a sleeping space can be independently controlled. The two-circuit underfloor heating enables separate control of living room and bathroom.



The on-board 230 V power supply in the standard version is ensured by two gel batteries with a total capacity of 340 Ah and a sinus inverter (1600 W continuous output and 3000 W peak output).



Highlights



CREDO

CARVER

CHARISMA

CRUISER DAILY

CRUISER ATEGO

LINER

CENTURION



Concorde



CONCORDE
Genève - RICHTEL - 04122-10111



CRUISER



CRUISER



ATEGO

1230

CONCORDE

Concorde REGENERABLE • D-RENO Autotech

LIVE LIKE AT HOME

The living room in the rear is designed as a spacious living space with high-quality seating as well as visually and functionally designed furnishings for an exclusive atmosphere. The kitchen impresses with an ingenious storage system, with optimum, model-dependent equipment such as a three-burner stove, single-lever mixer tap, stainless steel kitchen sink, refrigerator, oven and microwave.

Interior



Learn about the large selection of furniture front panels and seating group variants with their leathers and fabrics.





CRUISER 890 RLA

CREDO

CARVER

CHARISMA



CRUISER 890 RLA

CRUISER DAILY

CRUISER ATEGO

LINER

CENTURION



CRUISER 890 RLA

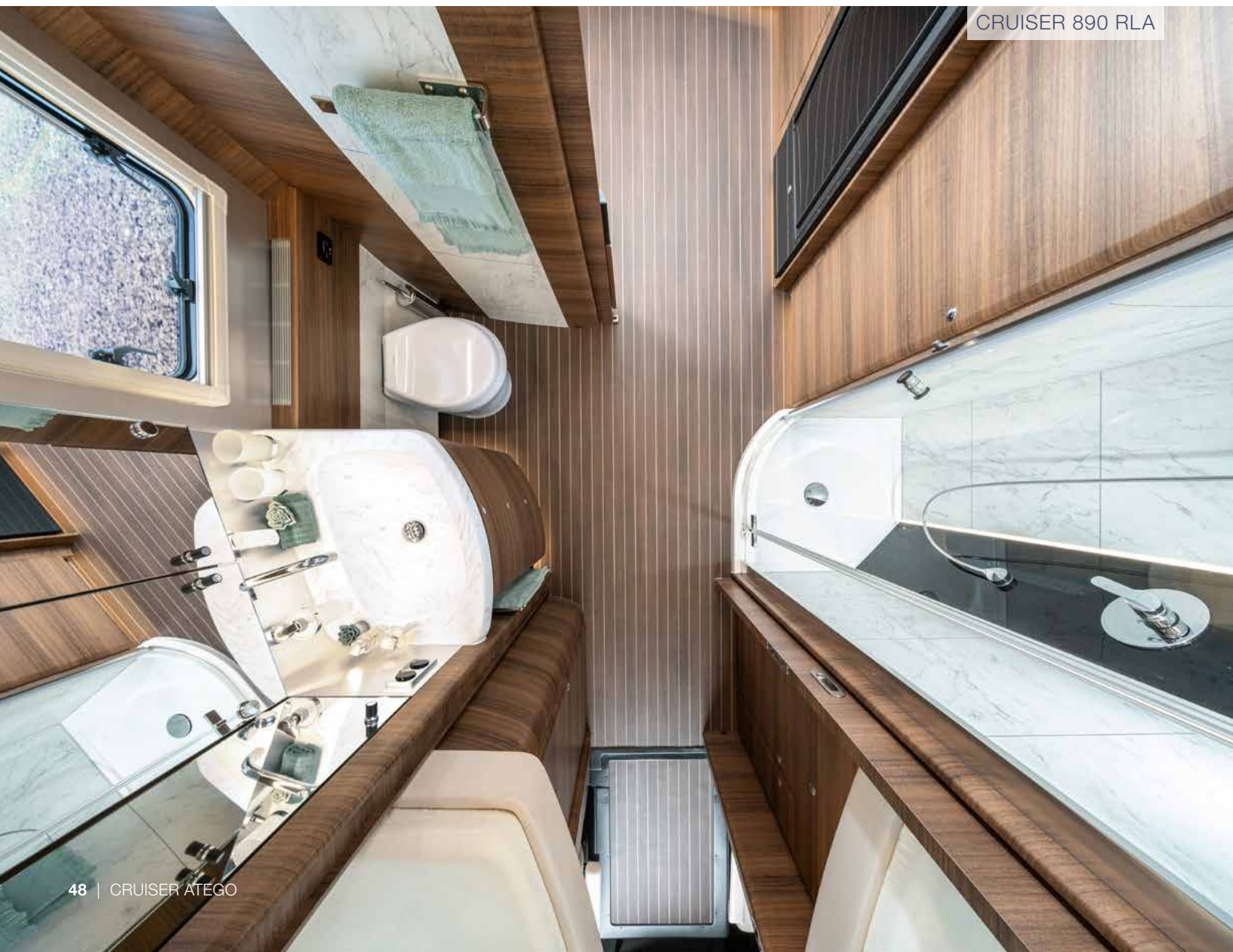

CRUISER 890 RLA

OASES OF WELL-BEING AND TRANQUILLITY

The premium and spacious bathroom with shower and toilet as well as large washbasin with storage areas is tailored perfectly to meet your body care requirements. The underfloor heating completes the circle of all-round well-being.

The alcove double bed ensures peaceful and restful sleep with a luxury mattress system and high head clearance. Alcove side windows and skylights convey the atmosphere of a quiet oasis with heavenly view.

CRUISER 950 LSA



CREDO

CARVER

CHARISMA

CRUISER DAILY

CRUISER ATEGO

LINER

CENTURION

Technical data



890 RLA

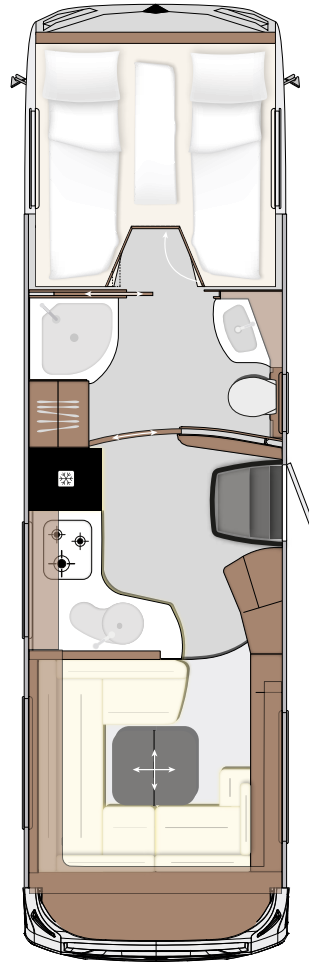

BASIC VEHICLE	MB Atego
OVERALL LENGTH (mm)	8985
OVERALL WIDTH (mm)	2500
OVERALL HEIGHT (mm)	3860
MAXIMUM TECHNICALLY-AUTHORISED GROSS VEHICLE WEIGHT (kg)	11990
PAYLOAD (kg)	3485

950 LSA

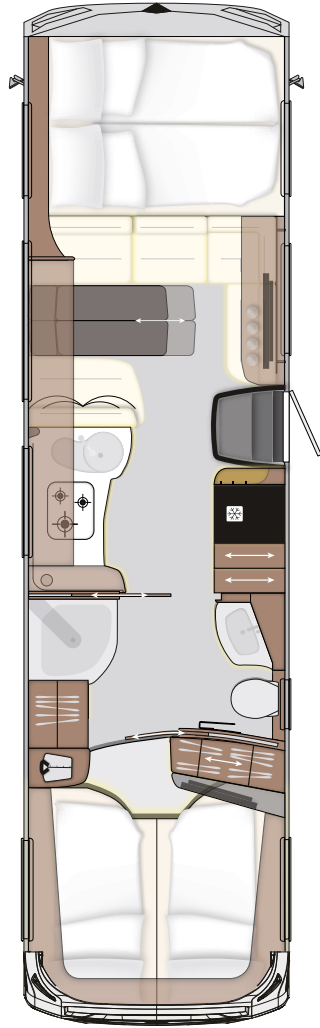

MB Atego

9625

2500

3860

11990

3305

CREDO

CARVER

CHARISMA

CRUISER DAILY

CRUISER ATEGO

LINER

CENTURION

LINER

PREMIUM LUXURY ACROSS THE ENTIRE LINE

Concorde Liners are in a class of their own. Exceptional high-end furnishings and maximum use of space are perfectly combined with one another here.

This class is paired with impressive mass. Based on the Mercedes-Benz Atego with 299 hp output or the Mercedes-Benz Actros with up to 450 hp output, this premium vehicle, with a gross vehicle weight of more than 12 tonnes, a length of up to 11.50 m and width of nearly 2.50 meters, moves majestically along roads and through the countryside.

Price list

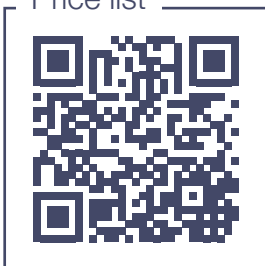

Exterior



Light creates atmosphere. Indirect lighting in the canopy illuminates the furniture and makes the wood shine, even at floor level thanks to the dimmable LED lighting in the skirting boards.



The active dashboard surrounds the driver with ergonomic curves. The monitors positioned on either side of the steering wheel are easily visible and the function switches and levers are within optimum reach.



The multifunctional adjustable hot water heating system creates four different warm areas which can be heated separately from each other. By means of a thermostatic valve, the temperature of the driver's cab, living room, wellness area and sleeping space can be independently controlled. The two-circuit underfloor heating enables separate control of living room and bathroom.



The emergency brake assistant and the lane departure warning system provided as standard ensure your safety. The radar system of the emergency brake assistant detects obstacles and intervenes if there is no driver activity. The camera of the lane departure warning system helps the driver stay in lane.



Highlights



CREDO

CARVER

CHARISMA

CRUISER DAILY

CRUISER ATEGO

LINER

CENTURION

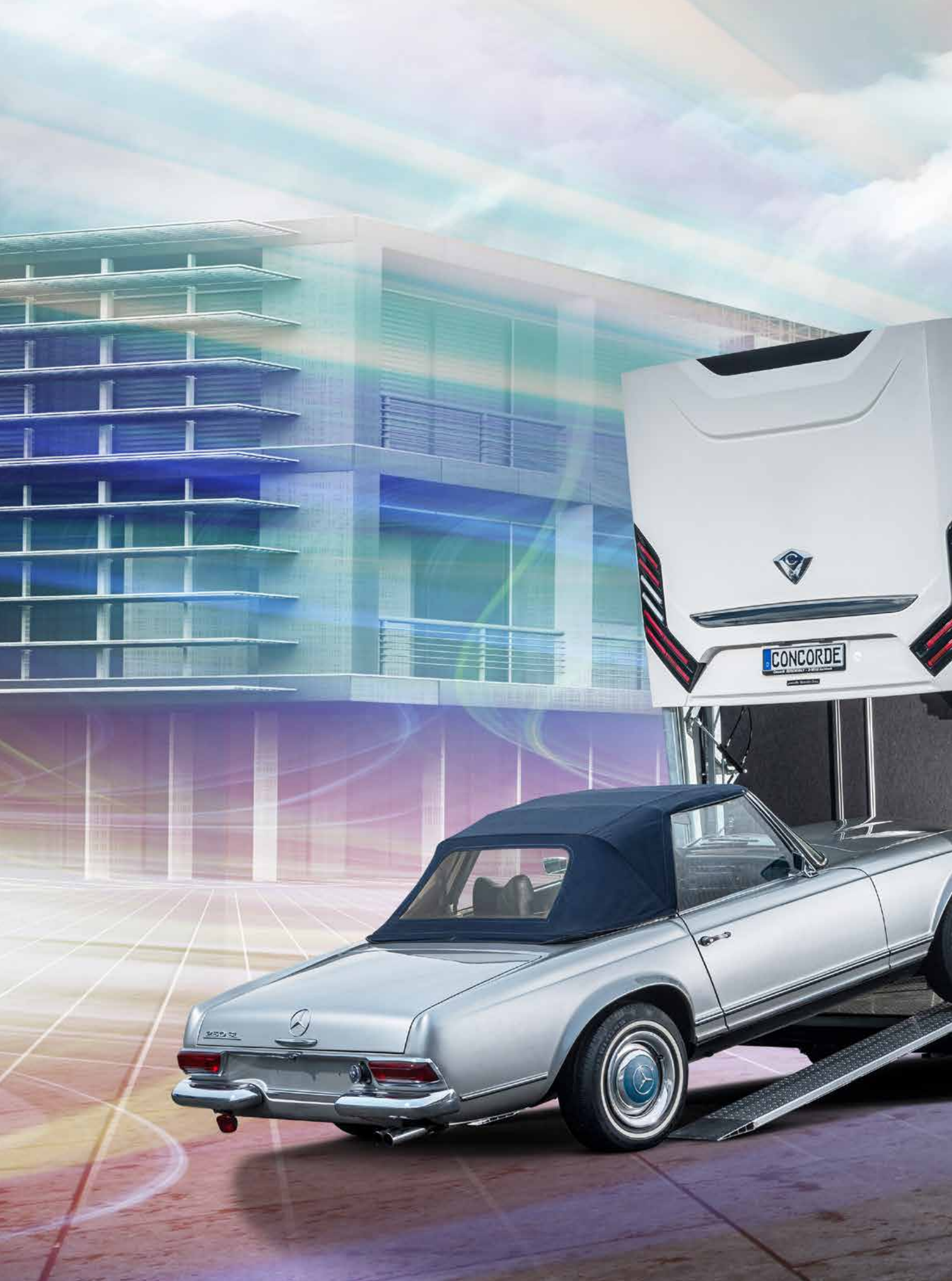

CONCORDE

300 SL





LINER





LIVING ENVIRONMENT AND KITCHEN STUDIO

Liners are characterized by stylistically confident furnishings and features. The finest materials and best workmanship as well as a model-dependent and individually selectable furnishings give personal and exclusive taste free rein. A special flooring in yacht-style look and with best ratings for walking comfort round out the tasteful ensemble.

The U-shaped kitchen impresses with typical, high-quality household kitchen appliances, very spacious cabinets and drawers as well as generous work surfaces. In addition to an optimally balanced functionality, attention is also given here to an exclusive design.

Interior



Learn about the large selection of furniture front panels and seating group variants with their leathers and fabrics.

LINER 996 MI



CREDO

CARVER

CHARISMA

CRUISER DAILY

CRUISER ATEGO

LINER

CENTURION

WELLNESS OASIS AND RELAXATION CENTRE

The bathroom with 5-star ambience. Tastefully furnished with spacious feeling. High-quality stainless-steel fittings and sink made of artificial stone convey an exclusive wellness atmosphere.

The bedroom as a centre of relaxation. In the generously dimensioned rear bedroom, the high-quality Concorde sleeping system with comfortable cold-foam mattress and stable spring base ensures maximum comfort. The substantial dimensions of the queen-size bed or twin-bed variant create a feeling of total relaxation. This is true for the optional pull-down bed as well.

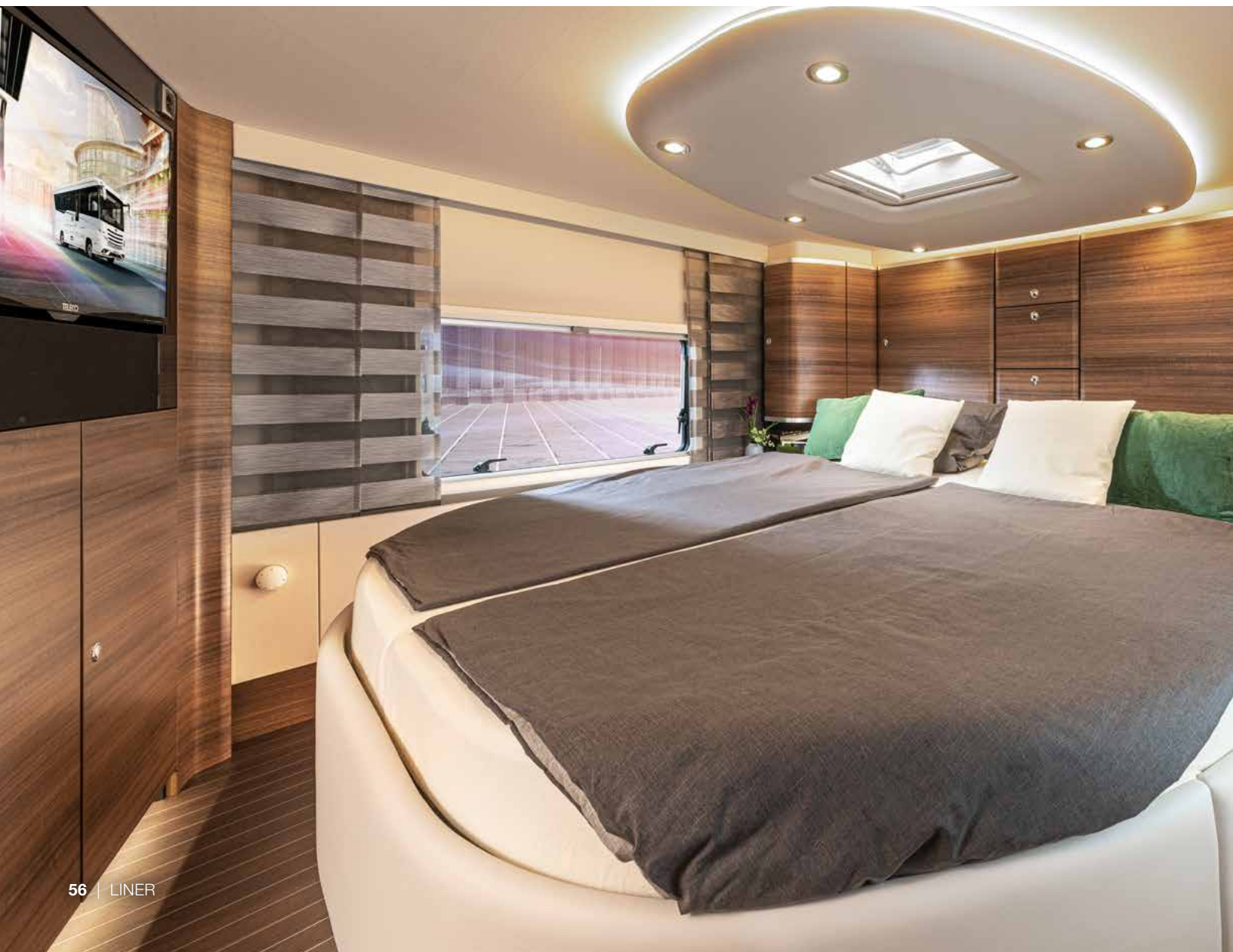



CREDO

CARVER

CHARISMA

CRUISER DAILY

CRUISER ATEGO

LINER

CENTURION

Technical data



940 LSI

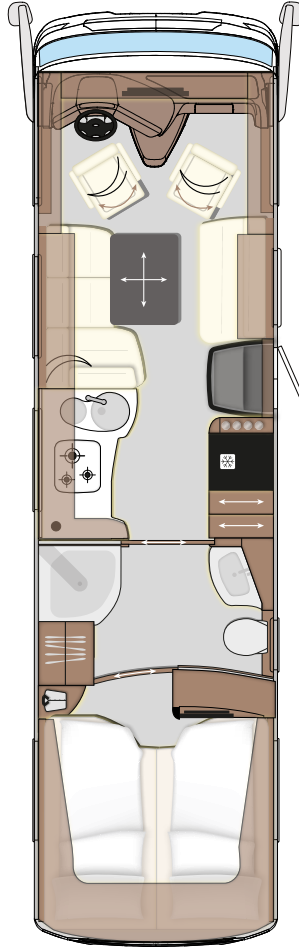

BASIC VEHICLE	MB Atego
OVERALL LENGTH (mm)	9485
OVERALL WIDTH (mm)	2500
OVERALL HEIGHT (mm)	3780
MAXIMUM TECHNICALLY-AUTHORISED GROSS VEHICLE WEIGHT (kg)	11990
PAYLOAD (kg)	3150

945 LSI

940 MI

945 MI

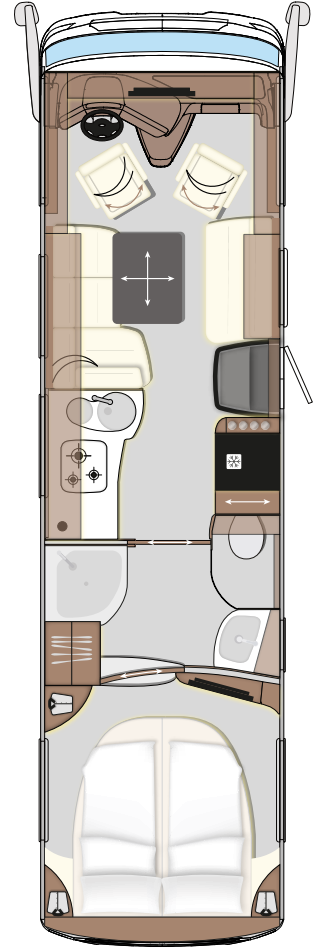
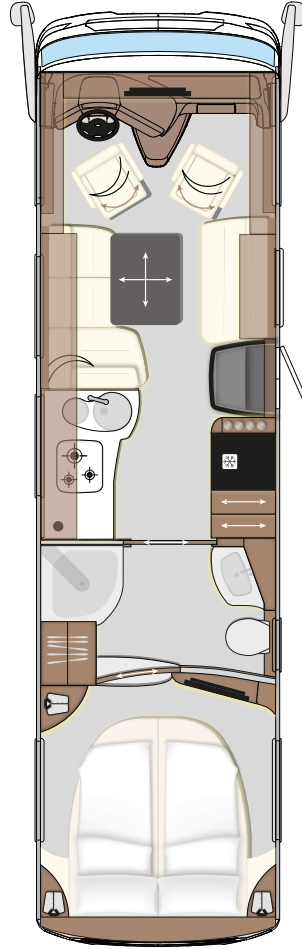
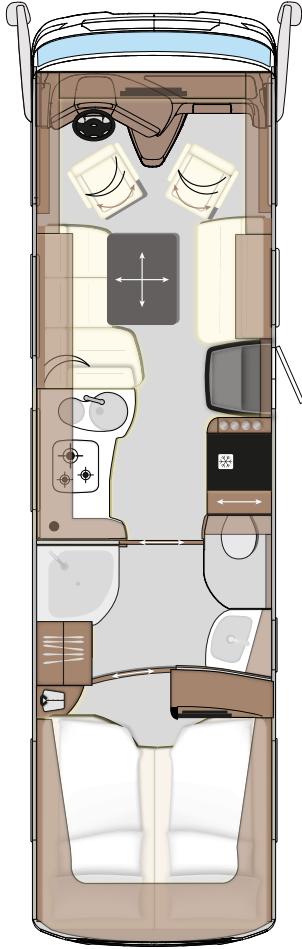

MB Atego

9485

2500

3780

11990

3150

MB Atego

9485

2500

3780

11990

3150

MB Atego

9485

2500

3780

11990

3150

CREDO

CARVER

CHARISMA

CRUISER DAILY

CRUISER ATEGO

LINER

CENTURION

Technical data



996 MI

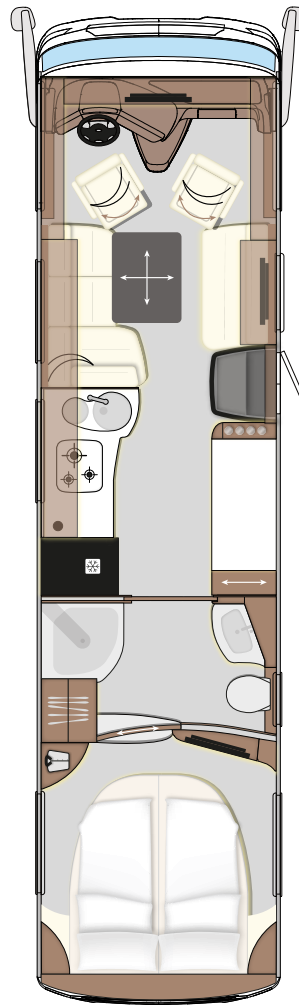

BASIC VEHICLE	MB Atego
OVERALL LENGTH (mm)	9985
OVERALL WIDTH (mm)	2500
OVERALL HEIGHT (mm)	3780
MAXIMUM TECHNICALLY-AUTHORISED GROSS VEHICLE WEIGHT (kg)	11990
PAYLOAD (kg)	2850

995 MI

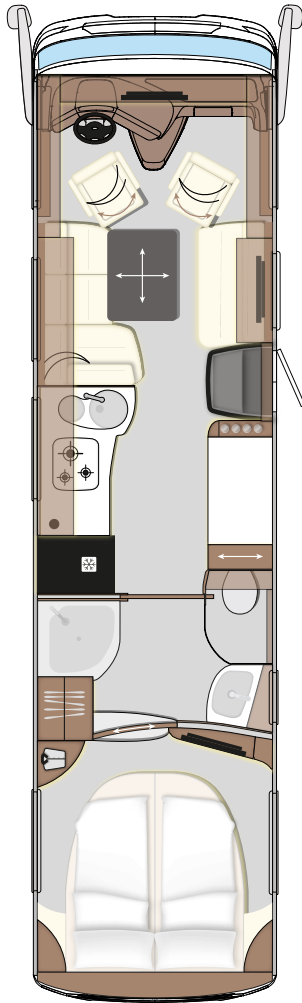

MB Atego

9985
2500
3780
11990
2850

990 GI

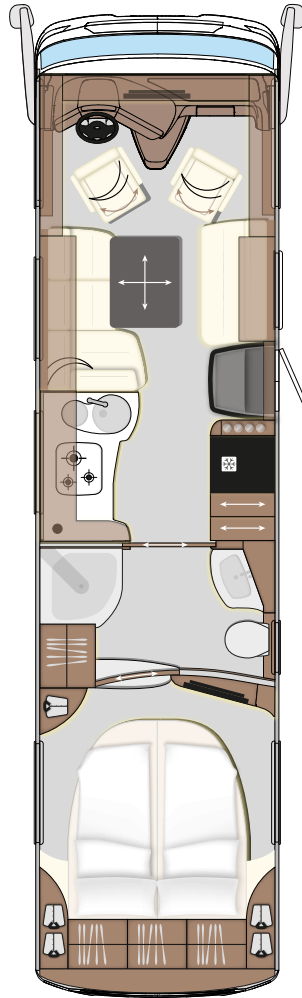

MB Atego

9985
2500
3780
11990
2760

MB Actros

10065
2500
3850
18000
6260



995 GI

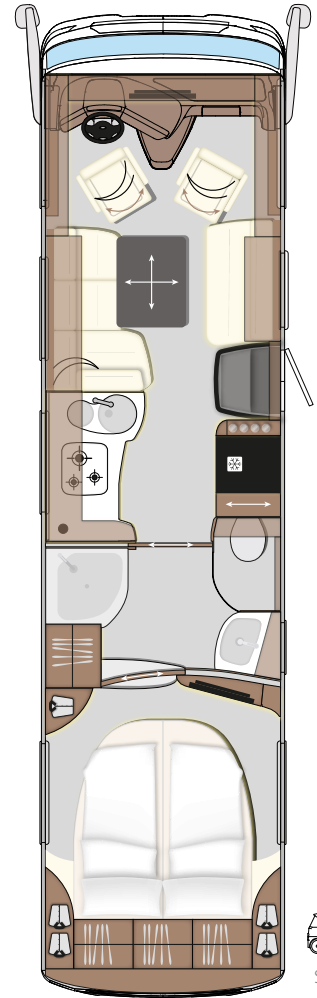

MB Atego

9985
2500
3780
11990
2760

MB Actros

10065
2500
3850
18000
6260



CREDO

CARVER

CHARISMA

CRUISER DAILY

CRUISER ATEGO

LINER

CENTURION

Technical data



1090 GI

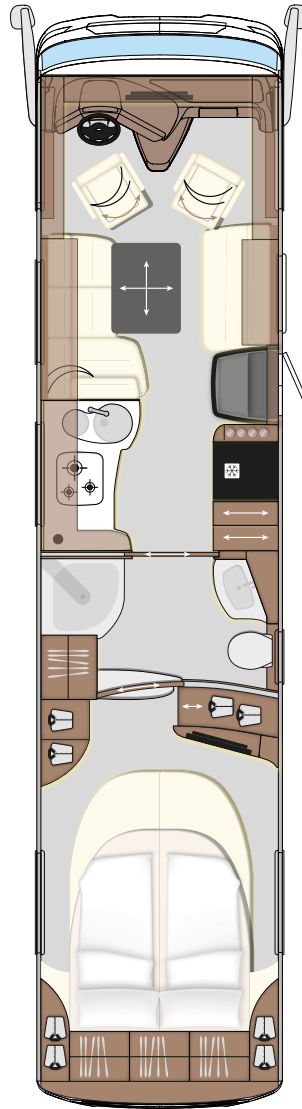

Mini Cooper SD



Fiat 500
Fiat Abarth 500

BASIC VEHICLE	MB Atego	MB Actros
OVERALL LENGTH (mm)	10985	11065
OVERALL WIDTH (mm)	2500	2500
OVERALL HEIGHT (mm)	3780	3850
MAXIMUM TECHNICALLY-AUTHORISED GROSS VEHICLE WEIGHT (kg)	15000	18000
PAYLOAD (kg)	5560	6050

1095 GI

1090 GIO

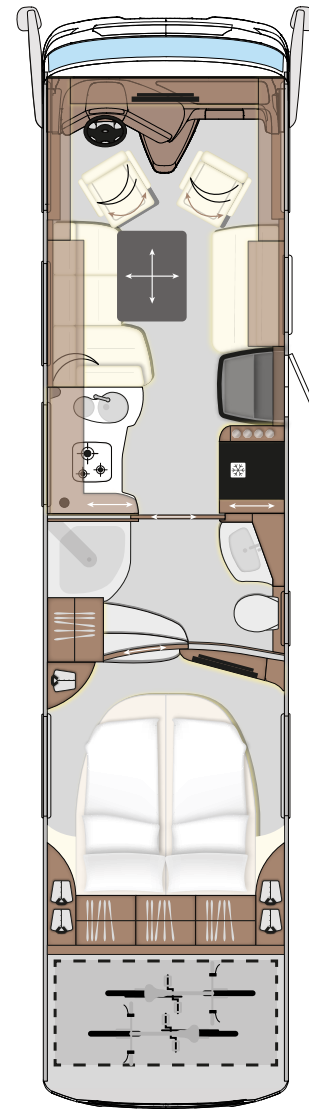
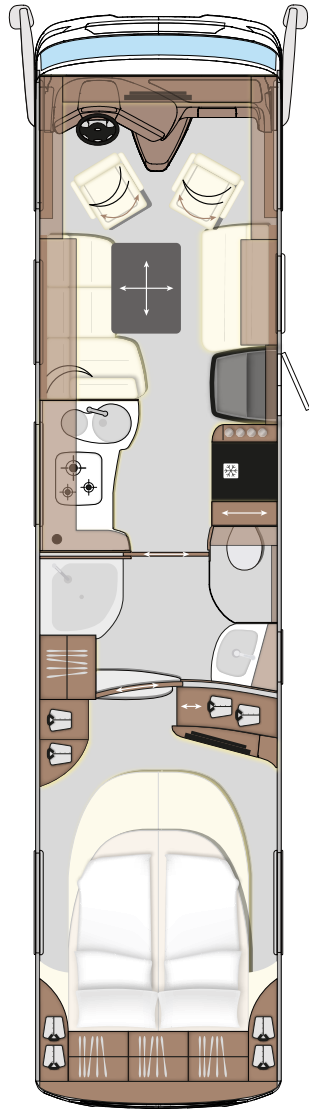

Mini Cooper SD



Fiat 500
Fiat Abarth 500

MB Atego	MB Actros
10985	11065
2500	2500
3780	3850
15000	18000
5560	6050

MB Atego	MB Actros
10985	11065
2500	2500
3780	3850
15000	18000
5750	6240

* Multivariable garage for passenger cars up to 4.30 m in length and a maximum weight of 1,400 kg. Individual check necessary.

CENTURION

THE MEASURE OF ALL THINGS

The absolute high-end motorhome is called Centurion. These vehicles, as partially integrated or integrated version, combine everything that deserves the label of luxury and are the result of years of successful experience and development.

Comfort on the highest level, technology of the highest standard, innovation in all areas and unique design and styling all go to make this vehicle our masterpiece.

Price list



Exterior

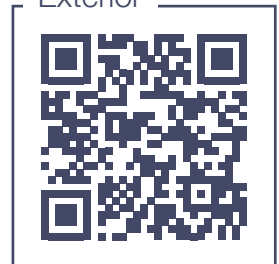

The technical masterpiece expands the living area and kitchen at the touch of a button, creating a room divider and a „star-worthy“ workplace thanks to the extendable worktop. The Havana lounge with relax function is a novelty and brings unimagined relaxation and comfort to the motorhome.



An aluminium frame in the Centurion's double floor ensures an extremely stable "basement construction" by connecting the auxiliary frame with the living area floor, creating a solid box.

This clever construction means that furniture and wall constructions remain firmly connected in the long run.

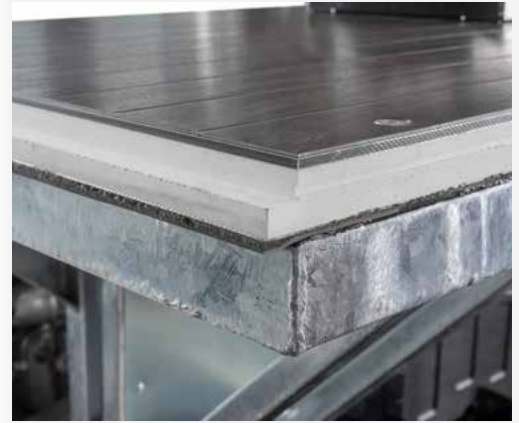

Concorde lift-up system not only a technical highlight. This rear garage door is raised hydraulically.



The hydraulic cylinders of the lift prop system are mounted on load-bearing outriggers which increase the span by approx. 90 cm and thus ensure a more stable stand.



Highlights



CREDO

CARVER

CHARISMA

CRUISER DAILY

CRUISER ATEGO

LINER

CENTURION



CENTURION







CENTURION

IMPOSING APPEARANCE AND PURE LUXURY

Be inspired by our partially integrated model, which owing to its striking original driver's cab with wide-beam bar and four headlights as well as air horns mounted on the left and right, is an impressive sight.

The draped bus flaps give the vehicle a harmonious overall appearance, while the electronic locks and gas pressure absorbers are safely located in the protected area of the double floor. Thanks to the aluminium hinge strips with rubber core on which the flaps are mounted, no water can penetrate between the side wall and flap when the flap is open.

An absolute technical masterpiece is the living area with kitchen, which can be extended at the push of a button – thanks to the slide-out. The Havana lounge provides you with an unexpected level of relaxation and comfort in your motorhome. The monoblock outdoor staircase with large, illuminated steps and a stainless steel handrail ensures absolute safety when boarding.





CREDO

CARVER

CHARISMA

CRUISER DAILY

CRUISER ATEGO

LINER

CENTURION

TECHNICAL REFINEMENTS FOR MORE SAFETY AND COMFORT

A technical highlight and unique feature is the Concorde lift-up system. With this patented hydraulic system, the door is automatically raised or lowered and securely locked at the push of a button.

Our striking spoiler, which contains an integrated camera for the bird's eye view system, ensures a clear rear view when manoeuvring. In the dark, the integrated rear lights provide plenty of light.

In addition, our optional mirror cameras for integrated and partially integrated models have displays mounted on the A-pillars which ensure the necessary visibility to the rear.





CREDO

CARVER

CHARISMA

CRUISER DAILY

CRUISER ATEGO

LINER

CENTURION



CENTURION



CENTURION

Concorde



CONCORDE



CONCORDE

HAS KL 384



CENTURION

LUXURY AND COMFORT – THE MOBILE LIVING EXPERIENCE

The living area with Havana lounge and recliner chair, exclusive leather upholstery, practical table construction and multimedia equipment meets the highest standards.

Adjacent, and in the same style and of a similarly high standard, is the kitchen. Breathtaking styling, optimum space and comfort features similar to what you would find at home once again leave nothing to be desired.

Interior





CREDO

CARVER

CHARISMA



CRUISER DAILY

CRUISER ATEGO

LINER

CENTURION





AN ELDORADO FOR WELL-BEING AND TRANQUILLITY

The ambience of the Centurion bathroom is nearly indescribable. Generous floor plan with unbelievable storage space, unique rainforest shower, comfortable toilet and a functional washbasin are perfectly presented visually by large mirror surfaces and LED spots, creating a distinctive spatial impression.

The sleeping area is a fairytale oasis of tranquillity. The ensemble of designer furniture, perfect room illumination and a queen-size bed with respectable outer dimensions as well as perfect relaxation quality thanks to optimum mattress selection deserve the label of dreamlike.

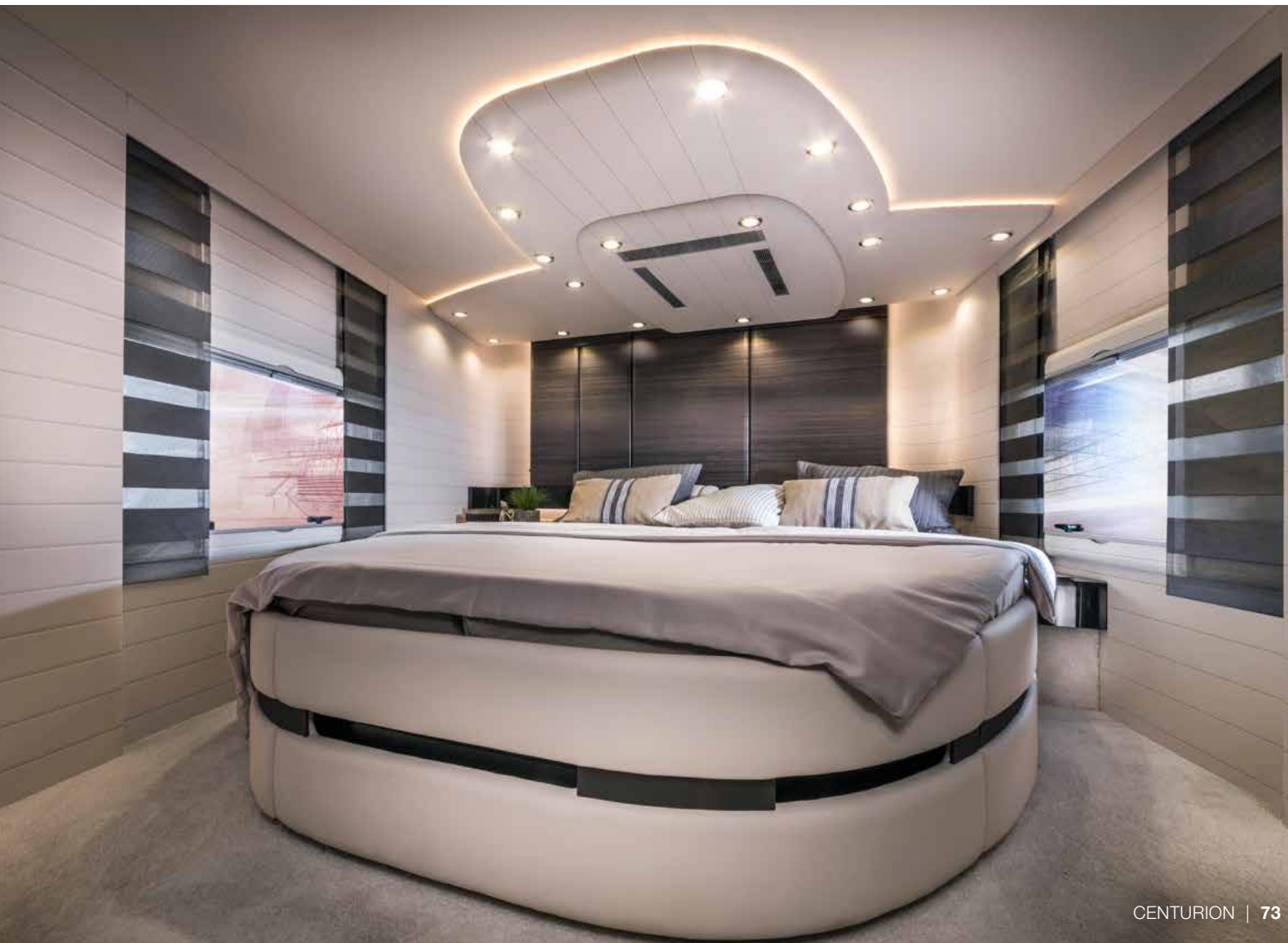

CREDO

CARVER

CHARISMA

CRUISER DAILY

CRUISER ATEGO

LINER

CENTURION

Technical data



1160 GSI

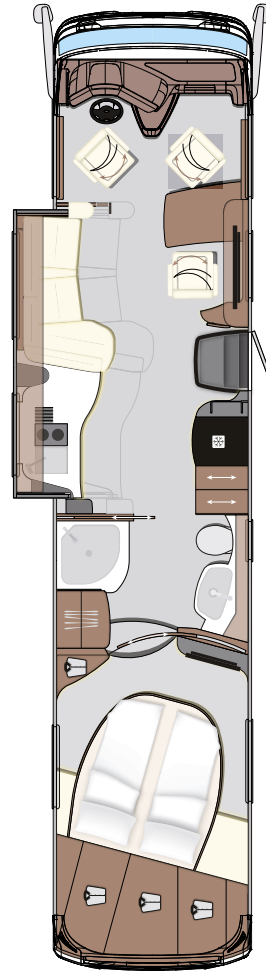

Fiat 500
Fiat Abarth 500

BASIC VEHICLE	MB Actros
OVERALL LENGTH (mm)	11730
OVERALL WIDTH (mm)	2500
OVERALL HEIGHT (mm)	3850
MAXIMUM TECHNICALLY-AUTHORISED GROSS VEHICLE WEIGHT (kg)	18000
PAYLOAD (kg)	2854

1165 GSI

1200 GSI

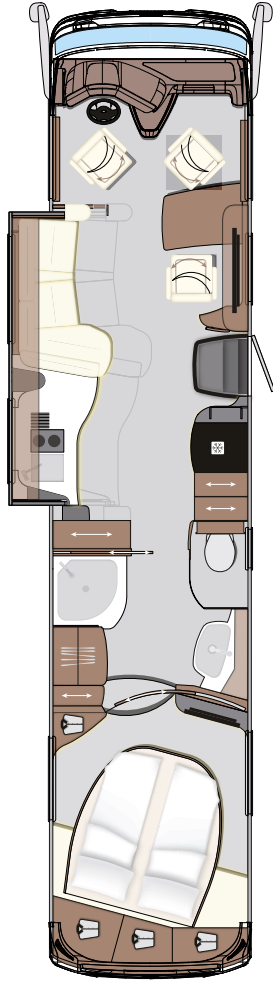

MB Actros

- 11730
- 2500
- 3850
- 18000
- 2854

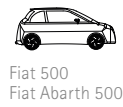
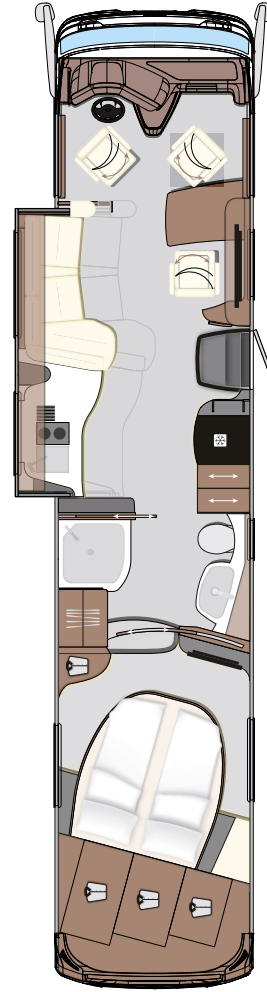

MB Actros

- 12000
- 2500
- 3850
- 18000
- 2700

CREDO

CARVER

CHARISMA

CRUISER DAILY

CRUISER ATEGO

LINER

CENTURION

Technical data



1205 GSI

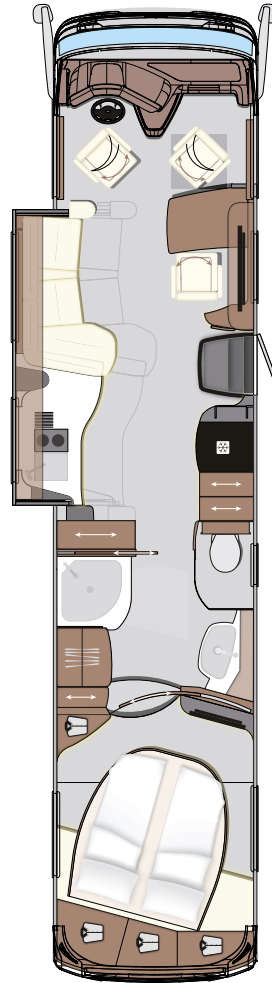

Smart 3

BASIC VEHICLE	MB Actros
OVERALL LENGTH (mm)	12000
OVERALL WIDTH (mm)	2500
OVERALL HEIGHT (mm)	3850
MAXIMUM TECHNICALLY-AUTHORISED GROSS VEHICLE WEIGHT (kg)	22000
PAYLOAD (kg)	5414

1200 GST

1205 GST

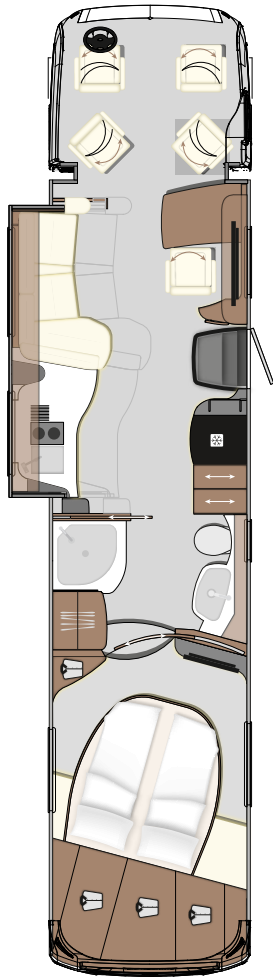

Fiat 500
Fiat Abarth 500

MB Actros

- 12000
- 2500
- 3850
- 22000
- 5414

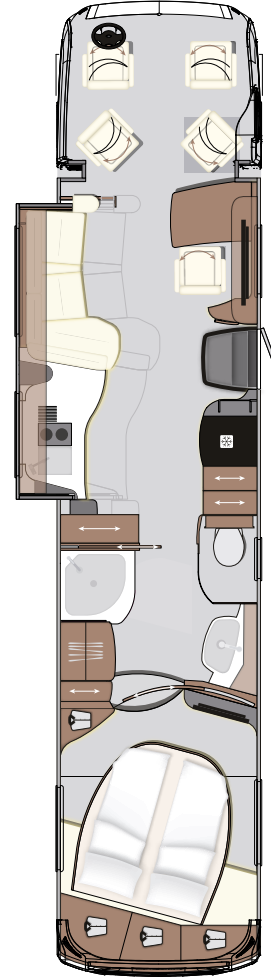

Smart 3

MB Actros

- 12000
- 2500
- 3850
- 22000
- 5414

CREDO

CARVER

CHARISMA

CRUISER DAILY

CRUISER ATEGO

LINER

CENTURION

THE CONCORDE FAMILY



During the year, we hold various events in Aschbach where the focus is on family togetherness. For us, a Concorde gathering means: Meeting up with friends, enjoying regional delicacies together, exchanging experiences and stories in a pleasant atmosphere where owners of other motorhome brands also always feel welcome and at ease.

Our guided tours too are always met with great enthusiasm because they provide a wonderful opportunity to go on short daytrips with friends and discover new things, to enjoy delicious meals or to explore outstanding landscapes and places of interest.





The well-prepared trips, which are conducted by foreign-language tour guides, give newcomers in particular the chance to get to know the Concorde family and the various vehicle models.

The 15 Concorde brand clubs organise joint gatherings and trips independently of each other. Anyone interested can plan their own gathering and also invite friends to come along to the event.

Our Concorde community members have an extremely diverse range of interests. But what connects us all is our love and passion for the Concorde brand.

For example, classic car fans meet up with people actively involved in car or motorcycle racing or with diving enthusiasts to talk and celebrate together. Owing to the sports activities, we have in the past been able to attract excellent cooperation partners who themselves are enthusiastic participants at the events.

It's easy to see why: Everyone finds their place and receives a warm welcome in our big, happy Concorde family.





Concorde

REISEMOBILE AUS LEIDENSCHAFT

Concorde Reisemobile GmbH
Concorde-Straße 2-4 · D-96132 Schlüsselfeld-Aschbach (Germany)
Phone +49 (0) 9555 9225-0 · Fax +49 (0) 9555 9225-44
Internet: www.concorde.eu · E-mail: info@concorde.eu

All information and figures apply for Concorde motorhomes from model year 2023. Model programmes, technical data and equipment features can differ from country to country. The design is based on StVO (German Road Traffic Act) and StVZO (German Road Traffic Licensing Regulations). We reserve the right to make changes, even without advance notice. Your Concorde dealer would be happy to give you current information. Please note that vehicles with special equipment are pictured which can deviate from the scope of delivery and standard equipment.